

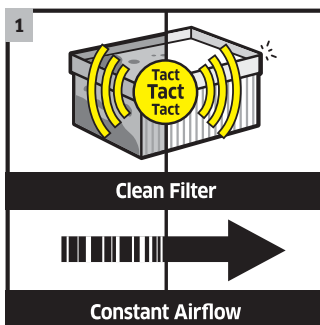

IVC 60/24-2 Tact²

High productivity, high filtration, single phase compact industrial vacuum with Tact² automatic filter clean system for heavy duty dust extraction.



1 Automatic Filter Cleaning System Tact²

- The filter cleans itself with powerful blasts of air. This automatic process guarantees constantly high suction power. Further benefits: low maintenance costs, long filter service life.
- Filter designed to allow uninterrupted use with consistently high suction power.

2 Two blower motors

- Two blowers for powerful cleaning action. The motors are electronically controlled, which avoids high starting currents.

3 Waste container with set-down mechanism

- The waste container with set-down mechanism ensures ergonomic emptying, even when the vacuumed waste is heavy.

4 With compact flat pleated filter

- The compact flat pleated filter allows a large filter area with a small and clear design.



IVC 60/24-2 Tact²

- Antistatic equipment
- Liquid cut-off
- Integrated pre-separation cyclone

Technical data

Order no.	1.576-100.0	
EAN code	4039784463691	
Current type	Ph / V / Hz	1 / 220 - 240 / 50 - 60
Air flow	l/s / m³/h	148 / 532
Vacuum	mbar / kPa	254 / 25,4
Container content	l	60
Rated input power	kW	2,4
Filter area	m²	0,95
Nominal size	ID 70	
Accessory nominal size	ID 50 / ID 40	
Sound pressure level	dB(A)	73
Dimensions (L × W × H)	mm	970 × 690 × 995

Equipment

Accessories included with machine	no
--	----

IVC 60/24-2 TACT² 1.576-100.0



1



2

		Order no.	Anzahl	Dummy	Dummy	Dummy	Price	Description	
Flat pleated filter (paper)									
Flat pleated filter (paper)	1	6.907-276.0	1 piece(s)					Paper, dust class M.	<input type="checkbox"/>
Flachfaltfilter (PTFE)									
Flat pleated filter, PTFE	2	6.907-449.0	1 piece(s)						<input type="checkbox"/>

Available accessories.

IVC 60/24-2 TACT² 1.576-100.0

KÄRCHER



		Order no.	Quantity	ID	Length / width	Price	Description	
Adapter Accessory								
Adapter DN50/DN51	1	9.989-603.0		DN 50				<input type="checkbox"/>
Adapter DN51/DN50	2	9.989-601.0		DN 50				<input type="checkbox"/>
Adapter DN50/DN61	3	9.989-602.0		DN 50				<input type="checkbox"/>
Adapter DN61/DN50	4	9.989-604.0		DN 50				<input type="checkbox"/>
Reducers								
Reducer DN 70/DN 50 (SBC)	5	9.977-772.0		DN 70				<input type="checkbox"/>
Reducer DN70/DN40	6	9.989-690.0		DN 70				<input type="checkbox"/>
	7	9.981-231.0		DN 50				<input type="checkbox"/>
Reducer V2A DN72 auf DN52	8	9.989-712.0		DN 70				<input type="checkbox"/>
Reducer V2A DN70/DN40	9	9.989-713.0		DN 70				<input type="checkbox"/>
Expanders								
	10	9.981-921.0		DN 50				<input type="checkbox"/>
Distributors								
Distributor DN70/DN50/DN50	11	9.989-611.0		DN 70				<input type="checkbox"/>
PVC								
Hose PVC DN40 3 m	12	9.989-647.0		DN 40				<input type="checkbox"/>
Hose PVC DN40 5 m	13	9.989-614.0		DN 40				<input type="checkbox"/>
Hose without connection PVC DN40 15 m	14	9.989-633.0		DN 40				<input type="checkbox"/>
Hose PVC DN50 3 m	15	9.989-615.0		DN 50				<input type="checkbox"/>
Hose PVC DN50 5 m	16	9.989-616.0		DN 50				<input type="checkbox"/>
Hose without connection PVC DN50 15 m	17	9.989-634.0		DN 50				<input type="checkbox"/>
Hose PVC DN40 1 m	18	9.989-626.0		DN 40				<input type="checkbox"/>
EVA								
Extension hose EVA el. DN42 3m	19	9.988-088.0		DN 40				<input type="checkbox"/>
Extension hose EVA el. DN42 5m	20	9.988-089.0		DN 40				<input type="checkbox"/>
Hose without connection EVA DN40 15 m	21	9.989-630.0		DN 40				<input type="checkbox"/>
Extension hose EVA el. DN52 3m	22	9.988-090.0		DN 50				<input type="checkbox"/>
Extension hose EVA el. DN52 5m	23	9.988-091.0		DN 50				<input type="checkbox"/>
Hose without connection EVA DN50 15 m	24	9.989-631.0		DN 50				<input type="checkbox"/>
ME								
Hose connection kit DN40	25	9.989-627.0		DN 40				<input type="checkbox"/>
Hose connection kit DN50	26	9.989-628.0		DN 50				<input type="checkbox"/>
PU								
Hose PU DN40 3 m	27	9.989-617.0		DN 40				<input type="checkbox"/>
Hose PU DN40 5 m	28	9.989-618.0		DN 40				<input type="checkbox"/>
Hose without connection PU DN40 15 m	29	9.989-637.0		DN 40				<input type="checkbox"/>
Hose PU DN50 3 m	30	9.989-619.0		DN 50				<input type="checkbox"/>
Hose PU DN50 5 m	31	9.989-620.0		DN 50				<input type="checkbox"/>
Hose without connection PU DN50 15 m	32	9.989-638.0		DN 50				<input type="checkbox"/>

Available accessories.

IVC 60/24-2 TACT² 1.576-100.0

KÄRCHER



		Order no.	Quantity	ID	Length / width	Price	Description	
ME-PU								
Hose ME-PU DN40 3 m	33	9.989-621.0		DN 40				<input type="checkbox"/>
	34	9.989-622.0		DN 40				<input type="checkbox"/>
Hose without connection ME-PU DN40 15 m	35	9.989-640.0		DN 40				<input type="checkbox"/>
Hose ME-PU DN50 3 m	36	9.989-623.0		DN 50				<input type="checkbox"/>
Hose ME-PU DN50 5 m	37	9.989-625.0		DN 50				<input type="checkbox"/>
Hose without connection ME-PU DN50 15 m	38	9.989-641.0		DN 50				<input type="checkbox"/>
Handles								
Hand grip curved 45°, DN 42	39	9.977-679.0		DN 40				<input type="checkbox"/>
Hand grip 45°, DN 52 ohne Sterngriff	40	9.977-678.0		DN 50				<input type="checkbox"/>
Hand grip curved stainless steel 45°IK D	41	9.989-036.0		DN 40				<input type="checkbox"/>
Hand grip curved stainless steel 45°, IK	42	9.988-111.0		DN 50				<input type="checkbox"/>
Elbow aluminium 45° DN40	43	9.989-544.0						<input type="checkbox"/>
Elbow aluminium 45° DN50	44	9.989-547.0						<input type="checkbox"/>
Suction tubes								
Suction tube 750 mm DN40	45	9.977-525.0		DN 40				<input type="checkbox"/>
Extension pipe 850mm DN 50, SBG	46	9.977-531.0		DN 50				<input type="checkbox"/>
Extension pipe stainless steel DN50 US	47	9.989-038.0		DN 40				<input type="checkbox"/>
Hand grip curved stainless steel 45°IK D	48	9.989-035.0		DN 50				<input type="checkbox"/>
Extension pipe stainless steel DN40 US	49	9.989-039.0		DN 40				<input type="checkbox"/>
Extension pipe stainless steel DN50 IK,	50	9.988-114.0		DN 50				<input type="checkbox"/>
Suction tube carbon 1500mm DN40	51	9.989-552.0		DN 40				<input type="checkbox"/>
Suction tube carbon 1500mm DN50	52	9.989-553.0		DN 50				<input type="checkbox"/>
Standard nozzles								
Standard nozzle PVC DN40	53	9.989-674.0		DN 40				<input type="checkbox"/>
Standard nozzle PVC DN50	54	9.989-673.0		DN 50				<input type="checkbox"/>
Nozzle elastic silicon DN42	55	9.988-401.0		DN 40				<input type="checkbox"/>
Nozzle elastic silicon DN52	56	9.988-402.0		DN 50				<input type="checkbox"/>
Standard nozzle rubber cuttable DN40	57	9.989-677.0		DN 40				<input type="checkbox"/>
Standard nozzle rubber cuttable DN50	58	9.989-675.0		DN 50				<input type="checkbox"/>
	59	9.980-748.0		DN 40				<input type="checkbox"/>
	60	9.980-749.0		DN 50				<input type="checkbox"/>
Standard nozzles bendable								
Nozzle, zinc coated, flexible, with rubber tip	61	9.981-420.0		DN 40				<input type="checkbox"/>
	62	9.981-421.0		DN 50				<input type="checkbox"/>
	63	9.981-429.0		DN 40				<input type="checkbox"/>
	64	9.981-430.0		DN 50				<input type="checkbox"/>

Available accessories.

IVC 60/24-2 TACT² 1.576-100.0

KÄRCHER



		Order no.	Quantity	ID	Length / width	Price	Description			
Floor nozzles										
Floor nozzle Alu 370 mm DN40	65	9.989-683.0		DN 40						<input type="checkbox"/>
Floor nozzle Alu el 370 mm DN40	66	9.989-682.0		DN 40						<input type="checkbox"/>
	67	9.981-426.0		DN 50						<input type="checkbox"/>
Floor nozzle Alu 370 mm DN50	68	9.989-664.0		DN 50						<input type="checkbox"/>
Multi-purpose nozzle 370mm el. leit., DN	69	9.987-612.0		DN 50						<input type="checkbox"/>
Floor nozzle Alu 500 mm DN50	70	9.989-684.0		DN 50						<input type="checkbox"/>
	71	9.981-925.0		DN 50						<input type="checkbox"/>
Multi-purpose nozzle 370mm el. leit., DN	72	9.989-558.0		DN 40						<input type="checkbox"/>
	73	9.988-115.0		DN 50						<input type="checkbox"/>
	74	9.981-923.0								<input type="checkbox"/>
Rubber lips with molding 370mm	75	9.981-914.0								<input type="checkbox"/>
	76	9.981-915.0								<input type="checkbox"/>
Bürstenleiste Satz elektr. leitend, für	77	9.984-939.0								<input type="checkbox"/>
	78	9.980-764.0								<input type="checkbox"/>
Crevice nozzles										
Crevice nozzle, lightweight plastic	79	9.988-117.0		DN 50						<input type="checkbox"/>
	80	9.981-482.0		DN 50						<input type="checkbox"/>
	81	9.981-442.0		DN 50						<input type="checkbox"/>
	82	9.981-465.0		DN 50						<input type="checkbox"/>
Crevice nozzles bendable										
Nozzle Langschaft Silikon DN52	83	9.988-403.0		DN 50						<input type="checkbox"/>
Nozzle Crevice nozzle bendable 11 mm x 5	84	9.989-681.0		DN 40						<input type="checkbox"/>
Crevice nozzle, zinc coated, flexible	85	9.981-423.0		DN 40						<input type="checkbox"/>
	86	9.981-424.0		DN 50						<input type="checkbox"/>
Crevice nozzle, zinc coated, flexible	87	9.981-425.0		DN 50						<input type="checkbox"/>
Surface nozzles										
Nozzle with connecting piece 90° DN40	88	9.988-118.0		DN 40						<input type="checkbox"/>
Nozzle with connecting piece 90° DN50	89	9.988-119.0		DN 50						<input type="checkbox"/>
Nozzle Surface nozzle Alu 150 mm DN40	90	9.989-666.0		DN 40						<input type="checkbox"/>
Nozzle Surface nozzle Alu 150 mm DN50	91	9.989-665.0		DN 50						<input type="checkbox"/>
Liquid nozzles										
	92	9.981-427.0		DN 50						<input type="checkbox"/>
Blind hole nozzles										
Nozzle Blind hole nozzle DN40	93	9.989-671.0		DN 40						<input type="checkbox"/>
Nozzle Blind hole nozzle bended 60° DN40	94	9.989-669.0		DN 40						<input type="checkbox"/>
Nozzle Blind hole nozzle bended 90° DN40	95	9.989-667.0		DN 40						<input type="checkbox"/>
Nozzle Blind hole nozzle bended 90° 200	96	9.989-670.0		DN 40						<input type="checkbox"/>

Available accessories.

IVC 60/24-2 TACT² 1.576-100.0

KÄRCHER



		Order no.	Quantity	ID	Length / width	Price	Description	
Standard brushes								
	97	9.981-431.0		DN 40				<input type="checkbox"/>
	98	9.981-432.0		DN 50				<input type="checkbox"/>
Pencil brushes								
Brush ø82 mm DN40	99	9.989-609.0		DN 40				<input type="checkbox"/>
Brush ø82 mm DN50	100	9.989-608.0		DN 50				<input type="checkbox"/>
Surface brushes								
Brush PP 24 mm DN40	101	9.989-610.0		DN 40				<input type="checkbox"/>
Vacuum brush	102	9.981-911.0		DN 40				<input type="checkbox"/>
	103	9.981-912.0		DN 50				<input type="checkbox"/>
Pre-separators								
Separator Tc Op Liquid 125 l DN70	104	9.989-686.0		DN 70				<input type="checkbox"/>
Liquids								
Kit liquid DN40	105	9.989-660.0		DN 40				<input type="checkbox"/>
Kit liquid DN50	106	9.989-661.0		DN 50				<input type="checkbox"/>
Liquid / Swarf								
Kit liquid swarf 3 m DN40	107	9.989-657.0		DN 40				<input type="checkbox"/>
Kit liquid swarf DN50	108	9.989-658.0		DN 50				<input type="checkbox"/>

Available accessories.