



IVC 60/30 Ap

High productivity, high filtration, three phase compact industrial vacuum with Ap semi-automatic filter clean system for dust extraction.



1 Wear-resistant side channel compressor

- A side channel blower delivers high suction power with a very long lifetime of at least 20,000 hours. These machines are therefore ideal for multiple shift operation.

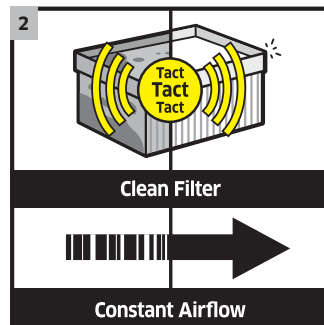

2 Automatic Filter Cleaning System Tact²

- The two filters are cleaned with targeted, powerful blasts of air. The procedure is triggered automatically, the suction power remains constantly high, and the work can be continued without interruption.
- Filter designed to allow uninterrupted use with consistently high suction power.



3 Waste container with set-down mechanism

- The waste container with set-down mechanism ensures ergonomic emptying, even when the vacuumed waste is heavy.



4 With compact flat pleated filter

- The compact flat pleated filter allows a large filter area with a small and clear design.



IVC 60/30 Ap

- Antistatic equipment
- Manual filter cleaning
- Integrated pre-separation cyclone

Technical data

Order no.	1.576-107.0	
EAN code	4039784539310	
Current type	Ph / V / Hz	3 / 400 / 50
Air flow	l/s / m³/h	68 / 244,8
Vacuum	mbar / kPa	286 / 28,6
Container content	l	60
Rated input power	kW	3
Filter area	m²	1,9
Nominal size	ID 70	
Accessory nominal size	ID 70 / ID 50 / ID 40	
Sound pressure level	dB(A)	77
Weight	kg	95
Dimensions (L x W x H)	mm	970 x 690 x 1240

Equipment

Accessories included with machine	no
--	----

IVC 60/30 AP 1.576-107.0



			Order no.	Quantity	ID	Length / width	Price	Description	
Adapter Accessory									
Adapter DN50/DN51	1	9.989-603.0			DN 50				<input type="checkbox"/>
Adapter DN51/DN50	2	9.989-601.0			DN 50				<input type="checkbox"/>
Adapter DN50/DN61	3	9.989-602.0			DN 50				<input type="checkbox"/>
Adapter DN61/DN50	4	9.989-604.0			DN 50				<input type="checkbox"/>
Reducers									
Reducer DN 70/DN 50 (SBG)	5	9.977-772.0			DN 70				<input type="checkbox"/>
Reducer DN70/DN40	6	9.989-690.0			DN 70				<input type="checkbox"/>
	7	9.981-231.0			DN 50				<input type="checkbox"/>
Reducer V2A DN72 auf DN52	8	9.989-712.0			DN 70				<input type="checkbox"/>
Reducer V2A DN70/DN40	9	9.989-713.0			DN 70				<input type="checkbox"/>
Expanders									
	10	9.981-921.0			DN 50				<input type="checkbox"/>
Distributors									
Distributor DN70/DN50/DN50	11	9.989-611.0			DN 70				<input type="checkbox"/>
PVC									
Hose PVC DN40 3 m	12	9.989-647.0			DN 40				<input type="checkbox"/>
Hose PVC DN40 5 m	13	9.989-614.0			DN 40				<input type="checkbox"/>
Hose without connection PVC DN40 15 m	14	9.989-633.0			DN 40				<input type="checkbox"/>
Hose PVC DN50 3 m	15	9.989-615.0			DN 50				<input type="checkbox"/>
Hose PVC DN50 5 m	16	9.989-616.0			DN 50				<input type="checkbox"/>
Hose without connection PVC DN50 15 m	17	9.989-634.0			DN 50				<input type="checkbox"/>
Hose PVC DN70 3 m	18	9.989-635.0			DN 70				<input type="checkbox"/>
Hose PVC DN70 5 m	19	9.989-643.0			DN 70				<input type="checkbox"/>
Hose without connection PVC DN70 15 m	20	9.989-636.0			DN 70				<input type="checkbox"/>
Hose PVC DN40 1 m	21	9.989-626.0			DN 40				<input type="checkbox"/>
EVA									
Extension hose EVA el. DN42 3m	22	9.988-088.0			DN 40				<input type="checkbox"/>
Extension hose EVA el. DN42 5m	23	9.988-089.0			DN 40				<input type="checkbox"/>
Hose without connection EVA DN40 15 m	24	9.989-630.0			DN 40				<input type="checkbox"/>
Extension hose EVA el. DN52 3m	25	9.988-090.0			DN 50				<input type="checkbox"/>
Extension hose EVA el. DN52 5m	26	9.988-091.0			DN 50				<input type="checkbox"/>
Hose without connection EVA DN50 15 m	27	9.989-631.0			DN 50				<input type="checkbox"/>
Hose EVA DN70 3 m	28	9.989-613.0			DN 70				<input type="checkbox"/>
Hose EVA DN70 5 m	29	9.989-624.0			DN 70				<input type="checkbox"/>
Hose without connection EVA DN70 15 m	30	9.989-632.0			DN 70				<input type="checkbox"/>
ME									
Hose connection kit DN40	31	9.989-627.0			DN 40				<input type="checkbox"/>
Hose connection kit DN50	32	9.989-628.0			DN 50				<input type="checkbox"/>
Hose connection kit DN70	33	9.989-629.0			DN 70				<input type="checkbox"/>

Available accessories.

IVC 60/30 AP 1.576-107.0

KÄRCHER



		Order no.	Quantity	ID	Length / width	Price	Description	
PU								
Hose PU DN40 3 m	34	9.989-617.0		DN 40				<input type="checkbox"/>
Hose PU DN40 5 m	35	9.989-618.0		DN 40				<input type="checkbox"/>
Hose without connection PU DN40 15 m	36	9.989-637.0		DN 40				<input type="checkbox"/>
Hose PU DN50 3 m	37	9.989-619.0		DN 50				<input type="checkbox"/>
Hose PU DN50 5 m	38	9.989-620.0		DN 50				<input type="checkbox"/>
Hose without connection PU DN50 15 m	39	9.989-638.0		DN 50				<input type="checkbox"/>
Hose PU DN70 3 m	40	9.989-644.0		DN 70				<input type="checkbox"/>
Hose PU DN70 5 m	41	9.989-645.0		DN 70				<input type="checkbox"/>
Hose without connection PU DN70 15 m	42	9.989-639.0		DN 70				<input type="checkbox"/>
ME-PU								
Hose ME-PU DN40 3 m	43	9.989-621.0		DN 40				<input type="checkbox"/>
	44	9.989-622.0		DN 40				<input type="checkbox"/>
Hose without connection ME-PU DN40 15 m	45	9.989-640.0		DN 40				<input type="checkbox"/>
Hose ME-PU DN50 3 m	46	9.989-623.0		DN 50				<input type="checkbox"/>
Hose ME-PU DN50 5 m	47	9.989-625.0		DN 50				<input type="checkbox"/>
Hose without connection ME-PU DN50 15 m	48	9.989-641.0		DN 50				<input type="checkbox"/>
Hose ME-PU DN70 3 m	49	9.989-646.0		DN 70				<input type="checkbox"/>
Hose ME-PU DN70 5 m	50	9.989-648.0		DN 70				<input type="checkbox"/>
Hose without connection ME-PU DN70 15 m	51	9.989-642.0		DN 70				<input type="checkbox"/>
Handles								
Hand grip curved 45°, DN 42	52	9.977-679.0		DN 40				<input type="checkbox"/>
Hand grip 45°, DN 52 ohne Sterngriff	53	9.977-678.0		DN 50				<input type="checkbox"/>
Hand grip curved stainless steel 45°IK D	54	9.989-036.0		DN 40				<input type="checkbox"/>
Hand grip curved stainless steel 45°, IK	55	9.988-111.0		DN 50				<input type="checkbox"/>
Elbow aluminium 45° DN40	56	9.989-544.0						<input type="checkbox"/>
Elbow aluminium 45° DN50	57	9.989-547.0						<input type="checkbox"/>

Available accessories.

IVC 60/30 AP 1.576-107.0

KÄRCHER



		Order no.	Quantity	ID	Length / width	Price	Description			
Suction tubes										
Suction tube 750 mm DN40	58	9.977-525.0		DN 40						<input type="checkbox"/>
Extension pipe 850mm DN 50, SBG	59	9.977-531.0		DN 50						<input type="checkbox"/>
Extension pipe stainless steel DN50 US	60	9.989-038.0		DN 40						<input type="checkbox"/>
Hand grip curved stainless steel 45°IK D	61	9.989-035.0		DN 50						<input type="checkbox"/>
Extension pipe stainless steel DN40 US	62	9.989-039.0		DN 40						<input type="checkbox"/>
Extension pipe stainless steel DN50 IK,	63	9.988-114.0		DN 50						<input type="checkbox"/>
Suction tube carbon 1500mm DN40	64	9.989-552.0		DN 40						<input type="checkbox"/>
Suction tube carbon 1500mm DN50	65	9.989-553.0		DN 50						<input type="checkbox"/>
Standard nozzles										
Standard nozzle PVC DN40	66	9.989-674.0		DN 40						<input type="checkbox"/>
Standard nozzle PVC DN50	67	9.989-673.0		DN 50						<input type="checkbox"/>
Nozzle elastic silicon DN42	68	9.988-401.0		DN 40						<input type="checkbox"/>
Nozzle elastic silicon DN52	69	9.988-402.0		DN 50						<input type="checkbox"/>
Standard nozzle rubber cuttable DN40	70	9.989-677.0		DN 40						<input type="checkbox"/>
Standard nozzle rubber cuttable DN50	71	9.989-675.0		DN 50						<input type="checkbox"/>
	72	9.980-748.0		DN 40						<input type="checkbox"/>
	73	9.980-749.0		DN 50						<input type="checkbox"/>
Standard nozzles bendable										
Nozzle, zinc coated, flexible, with rubber tip	74	9.981-420.0		DN 40						<input type="checkbox"/>
	75	9.981-421.0		DN 50						<input type="checkbox"/>
	76	9.981-429.0		DN 40						<input type="checkbox"/>
	77	9.981-430.0		DN 50						<input type="checkbox"/>
Floor nozzles										
Floor nozzle Alu 370 mm DN40	78	9.989-683.0		DN 40						<input type="checkbox"/>
Floor nozzle Alu el 370 mm DN40	79	9.989-682.0		DN 40						<input type="checkbox"/>
	80	9.981-426.0		DN 50						<input type="checkbox"/>
Floor nozzle Alu 370 mm DN50	81	9.989-664.0		DN 50						<input type="checkbox"/>
Multi-purpose nozzle 370mm el. leit., DN	82	9.987-612.0		DN 50						<input type="checkbox"/>
Floor nozzle Alu 500 mm DN50	83	9.989-684.0		DN 50						<input type="checkbox"/>
	84	9.981-925.0		DN 50						<input type="checkbox"/>
Multi-purpose nozzle 370mm el. leit., DN	85	9.989-558.0		DN 40						<input type="checkbox"/>
	86	9.988-115.0		DN 50						<input type="checkbox"/>
	87	9.981-923.0								<input type="checkbox"/>
Rubber lips with molding 370mm	88	9.981-914.0								<input type="checkbox"/>
	89	9.981-915.0								<input type="checkbox"/>
Bürstenleiste Satz elektr. leitend, für	90	9.984-939.0								<input type="checkbox"/>
	91	9.980-764.0								<input type="checkbox"/>

Available accessories.

IVC 60/30 AP 1.576-107.0

KÄRCHER



		Order no.	Quantity	ID	Length / width	Price	Description	
Crevice nozzles								
Crevice nozzle, lightweight plastic	92	9.988-117.0		DN 50				<input type="checkbox"/>
	93	9.981-482.0		DN 50				<input type="checkbox"/>
	94	9.981-442.0		DN 50				<input type="checkbox"/>
	95	9.981-465.0		DN 50				<input type="checkbox"/>
Crevice nozzles bendable								
Nozzle Langschaft Silikon DN52	96	9.988-403.0		DN 50				<input type="checkbox"/>
Nozzle Crevice nozzle bendable 11 mm x 5	97	9.989-681.0		DN 40				<input type="checkbox"/>
Crevice nozzle, zinc coated, flexible	98	9.981-423.0		DN 40				<input type="checkbox"/>
	99	9.981-424.0		DN 50				<input type="checkbox"/>
Crevice nozzle, zinc coated, flexible	100	9.981-425.0		DN 50				<input type="checkbox"/>
Surface nozzles								
Nozzle with connecting piece 90° DN40	101	9.988-118.0		DN 40				<input type="checkbox"/>
Nozzle with connecting piece 90° DN50	102	9.988-119.0		DN 50				<input type="checkbox"/>
Nozzle Surface nozzle Alu 150 mm DN40	103	9.989-666.0		DN 40				<input type="checkbox"/>
Nozzle Surface nozzle Alu 150 mm DN50	104	9.989-665.0		DN 50				<input type="checkbox"/>
Liquid nozzles								
	105	9.981-427.0		DN 50				<input type="checkbox"/>
Blind hole nozzles								
Nozzle Blind hole nozzle DN40	106	9.989-671.0		DN 40				<input type="checkbox"/>
Nozzle Blind hole nozzle bended 60° DN40	107	9.989-669.0		DN 40				<input type="checkbox"/>
Nozzle Blind hole nozzle bended 90° DN40	108	9.989-667.0		DN 40				<input type="checkbox"/>
Nozzle Blind hole nozzle bended 90° 200	109	9.989-670.0		DN 40				<input type="checkbox"/>
Standard brushes								
	110	9.981-431.0		DN 40				<input type="checkbox"/>
	111	9.981-432.0		DN 50				<input type="checkbox"/>
Pencil brushes								
Brush ø82 mm DN40	112	9.989-609.0		DN 40				<input type="checkbox"/>
Brush ø82 mm DN50	113	9.989-608.0		DN 50				<input type="checkbox"/>
Surface brushes								
Brush PP 24 mm DN40	114	9.989-610.0		DN 40				<input type="checkbox"/>
Vacuum brush	115	9.981-911.0		DN 40				<input type="checkbox"/>
	116	9.981-912.0		DN 50				<input type="checkbox"/>
Pre-separators								
Separator Tc Op Liquid 125 l DN70	117	9.989-686.0		DN 70				<input type="checkbox"/>
Liquids								
Kit liquid DN40	118	9.989-660.0		DN 40				<input type="checkbox"/>
Kit liquid DN50	119	9.989-661.0		DN 50				<input type="checkbox"/>

Available accessories.

IVC 60/30 AP 1.576-107.0



		Order no.	Quantity	ID	Length / width	Price	Description	
Liquid / Swarf								
Kit liquid swarf 3 m DN40	120	9.989-657.0		DN 40				<input type="checkbox"/>
Kit liquid swarf DN50	121	9.989-658.0		DN 50				<input type="checkbox"/>

Available accessories.